

# Agenda & Notes

---

**2007-08: 1<sup>st</sup> Meeting**  
*of the*  
**Building & Works  
Committee**

Venue of the Meeting

Shastri Bhawan, MHRD

Date and Time of the Meeting

May 10, 2007 at 3.30 Hrs



PDPM  
Indian Institute of Information Technology, Design  
and Manufacturing Jabalpur



**AGENDA FOR MEETING OF BUILDING & WORKS  
COMMITTEE TO BE HELD ON 10<sup>th</sup> MAY 2007**

**Table of Contents**

| <b>Item Nos.</b> | <b>Agenda Item</b>   | <b>Page No.</b> |
|------------------|--|-----------------|
| B&WC/2007.1.1    | Opening remarks by the Chairman, B&WC.   | 1               |
| B&WC/2007.1.2    | Confirmation of the minutes of 2006/2 <sup>nd</sup> meeting of the Building & Works Committee held on February 09, 2007 at the Conference Hall, IIITDM, Jabalpur | 2               |
| B&WC/2007.1.3    | To consider preliminary estimate for Construction of Lecture Hall & Classroom Complex Phase I.   | 6               |
| B&WC/2007.1.4    | Any other items with the permission of the chair   | 7               |



**AGENDA ITEM B & WC/ 2007. 1. 1**

**Opening remarks of the Chairman, B & WC**



**AGENDA ITEM B&WC/2007.1.2**

**Confirmation of the minutes of 2006/II<sup>nd</sup> meeting of the Building & Works Committee held on February 09, 2007 at Conference Hall, IIITDM Jabalpur**

Minutes of the Second meeting of the Building & Works Committee held on February 09, 2007 were circulated to all the members & no comment were received. The minutes are confirmed. Copy of the minutes are placed at **Pages 3 to 7**



**MINUTES**  
**2006/2<sup>nd</sup> MEETING OF THE**  
**BUILDING AND WORKS COMMITTEE**  
**HELD ON FEBRUARY 09, 2007 AT CONFERENCE HALL,**  
**PDPM IIITDM, IT BHAWAN, RANJHI, JABALPUR**

**Present:**

1. Prof. Sanjeev Bhargav  
Director  
PDPMIITDM Jabalpur  
Chairman
2. Prof. Aparajita Ojha  
Professor  
PDPM IIIT DM Jabalpur  
Member
3. Shri B.K.Nema  
Superintending Engineer  
Public Works Department  
Jabalpur  
Member
4. Shri J. P. Singh  
Acting Registrar  
PDPM IIIT DM Jabalpur  
Secretary
5. Shri T. S. Anand  
A. E, PDPM IIIT DM  
Special  
Invitee

**Leave of Absence:**

1. Mrs. Seema Raj  
Member
2. Mr. Dilip Mehra  
Member
3. Mr. P. S. Manglani  
Member

| <b>B &amp; WC<br/>2006.1.1</b> | <b>Remarks by the Chairman</b> |
|--------------------------------|--------------------------------|
|--------------------------------|--------------------------------|

The Chairman welcomed all members of B & WC and apprised them of the decision of the Government of India to increase student strength by 54% which will have multifaceted implications on the planning and conceptualization of various academic buildings, Halls of Residence, various supporting services including other aspects.

He further informed the members about events related to the first call of tender for construction & development of phase I of Institute campus.



Members expressed their satisfaction on various developments and desired that pace of construction activities of the campus be further accelerated.

|                                |   |
|--------------------------------|---|
| <b>B &amp; WC<br/>2006.1.2</b> | <b>Confirmation of Minutes of the 1<sup>st</sup>/2005 Meeting of<br/>the B &amp; WC held on July 14, 2006</b> |
|--------------------------------|---|

Minutes of 1<sup>st</sup>/2006 meeting of B&WC were confirmed. Copy of minutes is placed at annexure pages AP1 to AP 3 of the Agenda.

|                                |  |
|--------------------------------|--|
| <b>B &amp; WC<br/>2006.1.3</b> | <b>To consider tenders received for the following works:<br/>1. Construction of Hall of Residence I (SH: CIVIL);<br/>and<br/>2. Construction of<br/>(a) Lecture Hall &amp; Class room complex (SH: CIVIL)<br/>(b) Core Lab Complex (SH: CIVIL)</b> |
|--------------------------------|--|

**1. Construction of Hall of Residence I (SH: CIVIL)**

Tenders for above work were invited from pre-qualified contractors and were received and opened on 20.01.07. The detailed memo forwarding tenders is placed at Annexure Page AP-4 to AP-7 of the Agenda. The outcome of the negotiation with lowest tenderer and recommendations were put up to the Committee. The memo forwarding tenders pertaining to the above work, and the note placed on the table (Annexure Pages P-1 to P-16) was considered by the members.

The Building & Works Committee accepts to award the tender at Rs.10, 49,41,232/- (Rs. Ten Crore Fortynine Lakh Fortyone Thousand Two Hundred Thirty Two only), an amount arrived at after negotiations and being within ten percent of sanctioned amount, in favour of M/s. N. M. Roof Designers Ltd they being the lowest of the tenders received.

**2. Construction of  
(a) Lecture Hall & Class room complex (SH: CIVIL)  
(b) Core Lab Complex (SH: CIVIL)**

Tenders for above work were invited from pre-qualified contractors and were received and opened on 20.01.07. The detailed memo forwarding tenders is placed at Annexure Page AP-8 to AP-12 of the Agenda. The lowest tender received is of M/s. Gupta Enterprise, New Delhi. The Committee went through the Note placed at P-17 to P-18 and made the following decisions:



(a) **Lecture Hall & Class Room Complex:**

In view of quoted amount being higher by 27.7 % of the sanctioned amount, the part of work pertaining to LHCLC be considered as cancelled in the present call of tender. Further, the Committee advised that a fresh call of tender on the above work should be made at the earliest.

At this juncture, the Committee advised that the architect be asked to review his design suitably before the fresh call of tenders.

(b) **Core Lab Complex:**

In view of the note placed at P-17 to P-18, it is recommended that the Chairman be authorized to negotiate with the lowest tenderer for the work of Core Lab Complex as per clause 16 of CPWD Form 6 in tender document and take the final decision on its behalf.

|                            |  |
|----------------------------|--|
| B & WC/2006 <del>1.4</del> | To consider Preliminary Estimate for the Construction of Dining Hall. (SH: Civil & Electrical) |
|----------------------------|--|

The concept drawings, design, specification and preliminary estimates were presented to the Committee. Committee suggested that this work be taken up immediately so as to make Hall of Residence 1 fully functional. Committee accepted the concept drawings, design, specification and Preliminary Estimates of the Dining Hall.

The B&WC accepted the Preliminary Estimates amounting to Rs. 187.24 Lacs and requested the Finance Committee to recommend the same to the Board of Governors for the administrative approval and the financial sanction for the above work.

|                               |  |
|-------------------------------|--|
| B & WC<br>2006 <del>1.5</del> | Any other item with the permission of chair. |
|-------------------------------|--|

The meeting ended with a vote of thanks to the Chair.

Sd/-  
J.P.Singh  
Actg Registrar

Sd/-  
Chairman  
Building and Works Committee



**AGENDA ITEM B&WC/2007.1.3**

**To consider Preliminary Estimate for Construction of Lecture Hall & Class room Complex Phase 1 (LHCRC-I)  
(SH: Civil, Electrical & Low side of Air Conditioning Works )**

The preliminary estimate for the Construction of Lecture Hall & Classroom Complex Phase 1 have been prepared on Delhi Plinth Area 1992. The details of estimate amounting to Rs. 631 lacs (Rs. Six Hundred Thirty One Lacs only) along with concept drawing, history, design & scope, specification are placed at Annexure Pages AP-1 to AP- 22 .The above cost of building does not have any provision for site development, internal roads and paths, horticulture operation, high side of air conditioning and furniture. The estimates for these items shall be put-up separately in due course of time.

**The B & WC is requested to accept the preliminary estimate amounting to Rs.631 Lacs and to request the Finance Committee to recommend the same to Board of Governors for administrative approval and expenditure sanction for the above work**





**AGENDA ITEM B & WC/ 2007. 1. 4**

**Any other items with the permission of the chair**



PDPM  
INDIAN INSTITUTE OF INFORMATION TECHNOLOGY  
DESIGN & MANUFACTURING JABALPUR

# **Annexure Pages**



**Name of work** : Construction of Lecture Hall & Class Room  
Complex Phase I.

**Head of Account** : Chargeable to Plan Budget.

*Preliminary estimate amounting to Rs. 631 Lacs (Rs Six Hundred Thirty One Lacs only) including 1.5% cost of project management + Architects Fees @ 5.612% (5% fees + 12.24% service tax on fees) & Contingencies (Rs. Five Lacs only, Lump sum) prepared by M/s Kanvinde Rai & Chowdhury, New Delhi to meet the cost of the above mentioned work.*

- History** :
- The initial brief was discussed based on the student strength in the coming years and it was decided to include two lecture halls of 250 capacity, four of 150 capacity, four classrooms of 75 capacity and six classrooms of 40 capacity along with necessary parking, toilets etc. The resulting design has sought to integrate the three clusters with support facilities around landscaped courts. The built form is envisaged as a two storey development connected by walkways. Parking is restricted to the periphery leaving the central pedestrian circulation spine predominantly pedestrian in nature thereby fostering greater interaction among the student community.
  - In the classroom cluster, the 40 seater classrooms were arranged on the first floor above the 75 seater classrooms at ground floor creating a terrace on the outer face. It was suggested that the terrace be made on the inner face that serves as an access corridor with the common roof for both the ground floor and first floor circulation.

A Committee was constituted by the Director vide office order no PDPM IIITDM /2006/340 dated June 27, 2006, to review and go through campus planning of Institute. The Committee met on 21-06-06 and subsequently on 29-06-06 in which Architect was also



present.. The minutes of meeting are placed at Annexure AP - 23 to AP - 24 .The following modifications in the plans presented by Architect were agreed upon

- Additional classrooms of 75 capacities in the stilted cycle path may be created.
- An additional toilet block and staircase near classroom is desirable.
- All loaded stilted structure should be designed carefully considering the earthquake consideration of latest IS code.
- All floors of all Academic building should have universal excess.

The earlier approved scheme for the Lecture Hall & Class Room Complex was reviewed by the Institute based on the student strength in the coming years and the space requirement in the immediate future. As an outcome of numerous discussions the Complex was finalized to comprise of

1. 2 No 250 capacity LH
2. 9 No. 80 capacity Class Room
3. 3 No. 96 capacity Class Room

All the above inputs were incorporated and the present proposal integrates the Class room cluster, 250 LH Complex and provision for future expansion with support facilities around landscaped courts. The built form is envisaged as a two storey development connected by partly covered walk ways. Parking is restricted to the periphery leaving the central circulation spine predominantly pedestrian in nature thereby fostering greater interaction among the student community.

**Design  
Scope**

**& :** The design of the proposed building has the following features:

The design of the proposed Lecture Hall & Class Room Complex comprises of

1. 2 Lecture Halls of 250 capacity
2. 9 Classroom of 80 capacity
3. 3 Classroom of 96 Capacity



catering to a student capacity of 1508 with a total built up area of 3710 sqm. The Complex as envisaged and designed now is provided with

- sufficient corridor width considering its future expansion of Phase II,
- adequate toilet facilities distributed in the various clusters
- adequate staircases and addition of a ramp towards creating a barrier free environment.

The Class Room Complex is on two floors with 3 CR of 96 capacity and 2 CR of 80 capacity on the ground floor with a stilted student interaction space as an extension of the central courtyard. On the first floor there are 6 CR of 80 capacity accessed by a covered corridor which open onto a internal courtyard. Since the class rooms are column free the roof structure is envisaged as a folded plate construction.

- the rear wall of the class rooms are acoustically paneled for better sound performance
- The class rooms are non air-conditioned
- roof is provided with hollow clay tiles over the waterproofing treatment as a passive measure towards achieving comfort levels in the non air-conditioned space.
- toilet facilities have been provided in a block adjoining the complex linked by the corridor.
- All class rooms are tiered with at least one access from the corridor level thereby ensuring all class rooms have universal access.

The 250 Lecture Hall cluster has the 2 Lecture Halls on the first floor with the ground floor being partly covered housing the utilities and the balance area is stilted with a linkage at the mid level with the Class Room Complex. The Lecture Hall being column free is provided with a folded plate roof conceived in a manner which assists in providing the required volume to the hall.

- The Lecture Hall has tiered floor, providing suitable visibility in the entire hall.



- The Lecture Hall has one access from the link corridor which is barrier free.
- The Lecture Hall is provided with acoustic wall paneling towards sound performance.
- The roof is provided with integrated waterproofing and insulation treatment towards cutting down air conditioning load
- False ceiling is limited to the area carrying the supply/return ducts since these Lecture Halls are air-conditioned

**Specification** : Brief specifications of work shall be as follows:

- i) Designed reinforced cement concrete for structural works.
- ii) All in fill walls shall be 300 mm thick cavity wall with insulation in air conditioned areas and without insulation remaining areas.
- iii) Flooring
  - a) Kota stone flooring with bands of jaisalmer in corridors, staircases, lecture halls and class rooms.
  - b) Vitrified tiles in toilets.
- iv) Glazed tile upto 2.1 meter in toilets.
- v) Washbasins in the toilets shall be provided on a granite counter.
- vi) Cement based integral water proofing treatment on overdeck insulation with china mosaic on the top.
- vii) 35 mm thick laminated flush door shutters on aluminum door frames.
- viii) Aluminum windows with insulated glass.
- ix) Stainless steel hardware on doors towards better performance and longer life considering that most shutters are from open corridors.
- x) Oil bound distemper for internal painting.
- xi) For external finish a combination of washed stone grit plaster, spectrum finish and stone cladding and exterior grade paint.
- xii) Pozolonna Portland Cement as per IS specifications for non structural works and Ordinary Portland Cement for



- structural works.
- xiii) CP fittings, white glazed sanitary wares, centrifugal cast iron pipes for sewer lines, GI pipes for water supply lines and PVC overhead tanks, and structure built-in parnalas for rain water.
  - xiv) False ceiling with gypsum boards to conceal the air-conditioning ducts.
  - xv) Acoustic paneling on the walls.
  - xvi) Electrical wiring with copper wire
  - xvii) Modular switches, energy efficient electrical fixtures.
  - xviii) Network, telephone connection and UPS wiring.
  - xix) Smoke detection system and fire alarms.

**Period of Construction** : Total Twelve months.

**Mode** : On contract through call of competitive Tenders.

**Sd/-**  
**(T. S. Anand)**  
AE,  
PDPM IITDM

**Sd/-**  
**(Rajeev Garg)**  
EE,  
IIT Kanpur

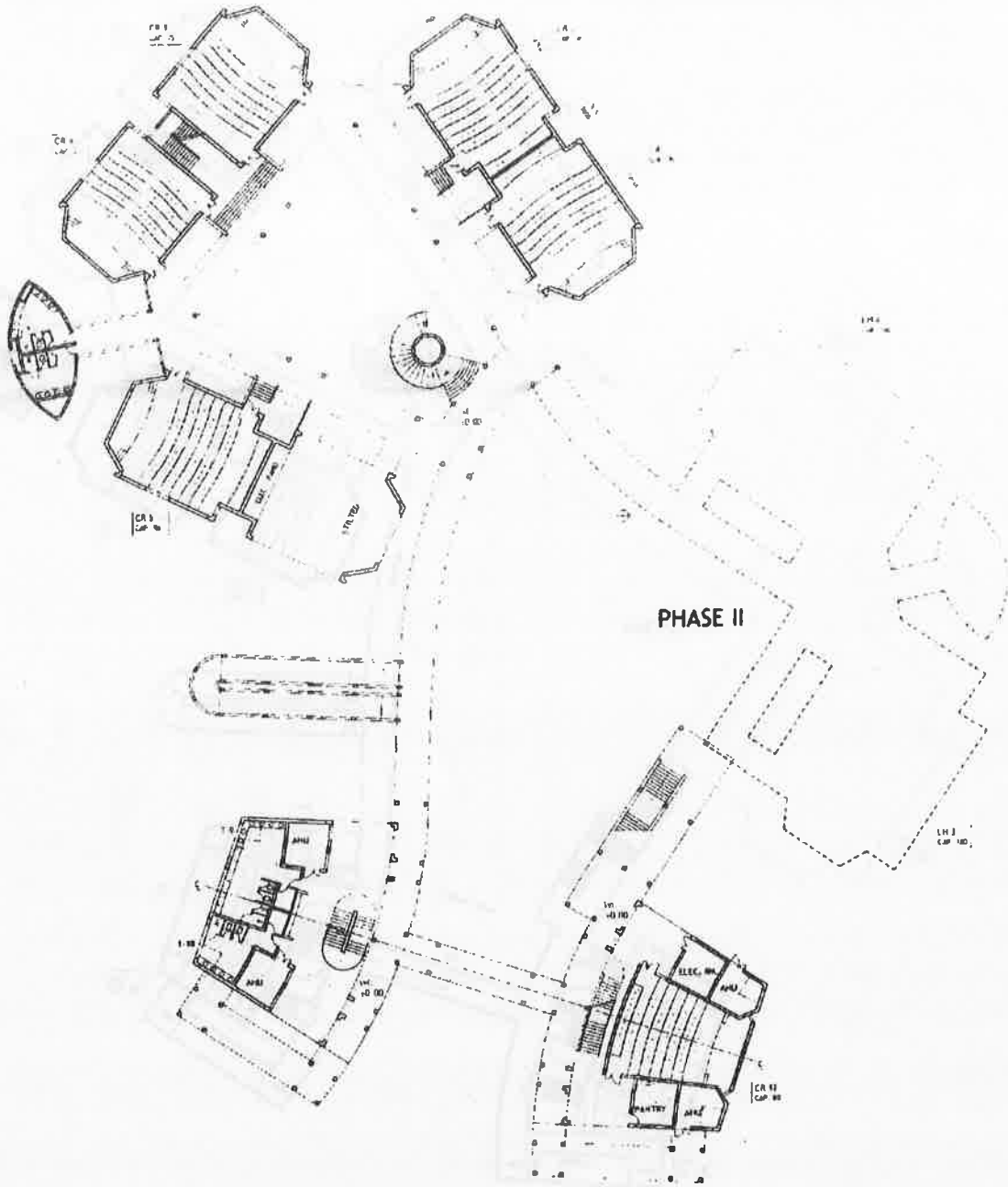

FUTURE EXPANSION  
 FOR LECTURE HALL  
 COMPLEX

P D P M I I I T D M J A B A L P U R

LECTURE HALL & CLASSROOM COMPLEX  
 Ground Floor Plan

1 : 400

Date  
 Mar '07

Dwg No

kanvinde rai & chowdhury  
 architects engineers & planners





### TOTAL CAPACITY

|                                |             |
|--------------------------------|-------------|
| 1 CLASSROOMS OF 80 CAP.        | 80          |
| 3 CLASSROOMS OF 96 CAP.        | 288         |
| 8 CLASSROOMS OF 80 CAP.        | 640         |
| 2 LECTURE HALLS OF 250 CAP.    | 500         |
| <b>TOTAL STUDENTS CAPACITY</b> | <b>1508</b> |

### AREA STATEMENT

#### LECTURE HALL AND CLASSROOM COMPLEX, IIIT JABALPUR

| SL.NO. |              | GROUND FLOOR<br>AREA (sq.m) | STILTED<br>AREA (sq.m) | FIRST FLOOR<br>AREA (sq.m) | STILTED<br>AREA (sq.m) |             |
|--------|--------------|-----------------------------|------------------------|----------------------------|------------------------|-------------|
| 1.     | LH 250       | 328                         | 203                    | 662                        | -                      |             |
| 2.     | LH 180       | -                           | -                      | -                          | -                      |             |
|        | ADD. ROOM    | -                           | -                      | -                          | -                      |             |
| 3.     | CR 80 / 96   | 666                         | 122                    | 756                        | -                      |             |
|        | ADD. ROOM    | 15                          | -                      | 42                         | -                      |             |
| 4.     | TOILET       | 58                          | -                      | 58                         | -                      |             |
| 5.     | STAIR        | -                           | 70                     | -                          | 70                     |             |
| 6.     | RAMP         | -                           | 106                    | -                          | -                      |             |
| 7.     | PASSAGE      | -                           | 869                    | -                          | 811                    |             |
|        | <b>TOTAL</b> | <b>1067</b>                 | <b>1370</b>            | <b>1518</b>                | <b>881</b>             | <b>4835</b> |

AREA ON GROUND FLOOR - 1067 SQM.

AREA ON FIRST FLOOR - 1518 SQM.

AREA FOR PASSAGE / RAMPS / STAIR / STILTED AREA @ HALF - 1125 sqm.

TOTAL BUILT UP AREA - 1067 + 1518 + 1125 = 3710 SQM.

$3710 / 1508 = 2.46 \text{ SQM / STUDENT}$

|                       |                                   |         |         |   |
|-----------------------|-----------------------------------|---------|---------|---|
| PDPM IIIT DM JABALPUR | LECTURE HALL & CLASSROOM COMPLEX  | Date    | Dwg No. | kanvinda rai & chowdhuri<br>architects engineers & planners |
|                       | Revised Capacity & Area Statement | Mar '07 |         |   |



| Name of work : Construction of LECTURE HALL & CLASS ROOM COMPLEX PHASE I at PDPM IIITDM Jabalpur. |        |   |      |      |      |              |                 |
|---|--------|---|------|------|------|--------------|-----------------|
| APPENDIX I  |        |   |      |      |      |              |                 |
| FRAMED STRUCTURE  |        |   |      |      |      |              |                 |
| Preliminary Estimate based on DPAR 92 & MR.   |        |   |      |      |      |              |                 |
| I : Civil Work (Based on DPAR-92 with C.I. = 205)   |        |   |      |      |      |              |                 |
| SL. NO.   | Code   | Description   | Unit | Qty. | Rate | Indexed Rate | Amount          |
| 1   | 1.1.1  | RCC Framed Structure :<br>RCC framed structure upto six storey's<br>Floor height 3.35 m | Sqm  | 3710 | 2920 | 5986         | 22208060        |
| 2   | 1.2    | Extra for :   |      |      |      |              |                 |
|   | 1.2.3  | Extra for 1.15m of additional floor height beyond normal floor height of 3.35m.         | Sqm  | 1700 | 479  | 982          | 1669907         |
|   |        | Extra for 1.65m of additional floor height beyond normal floor height of 3.35m.         | Sqm  | 660  | 688  | 1409         | 930217          |
|   |        | Extra for 1.95m of additional floor height beyond normal floor height of 3.35m.         | Sqm  | 1350 | 813  | 1666         | 2248666         |
| 3   | 1.2.8  | Resisting Earthquake forces   | Sqm  | 3710 | 250  | 513          | 1901375         |
| 4   | 1.2.12 | Larger modules over 35 sqm.   | Sqm  | 2890 | 220  | 451          | 1303390         |
| 5   | 1.2.13 | Termite proof treatment (On ground floor only)  | Sqm  | 2450 | 75   | 154          | 376688          |
| 6   | 1.2.14 | Fire fighting   | Sqm  | 3710 | 185  | 379          | 1407018         |
| 7   | DSR    | Extra shuttering for Folded plate structure (DSR Item Code No. 5.14.9 + 5.14.10 )       | Sqm  | 1500 | 578  | 714          | 1071029         |
|   |        | <b>Total A</b>  |      |      |      | <b>Rs.</b>   | <b>33116349</b> |
|   |        | <b>Building Cost (sl. No.1)</b>   |      |      |      |              | <b>22208060</b> |



| SL. NO. | Code       | Description   | Unit | Building Cost at sl. No.1 | Rate          | Indexed Rate | Amount          |
|---------|------------|---|------|---------------------------|---------------|--------------|-----------------|
|         | <b>3</b>   | <b>Services :</b>   |      |                           |               |              |                 |
| 8       | 3.1        | Internal water supply and sanitary installation               |      | 22208060                  | 4%            |              | 888322          |
| 9       | 3.2        | External service connections                                  |      | 22208060                  | 5%            |              | 1110403         |
|         |            | <b>Total B</b>  |      |                           |               | <b>Rs.</b>   | <b>1998725</b>  |
|         |            | <b>II : Electrical Work</b>                                   |      | <b>Building cost</b>      |               |              |                 |
| 10      | 3.3        | Internal electrical installations                             |      | 22208060                  | 15.00%        |              | 3331209         |
|         |            | <b>Total C</b>  |      | <b>Total</b>              | <b>15.00%</b> |              | <b>3331209</b>  |
|         | <b>3.6</b> | <b>Extra for superior specifications based on DPAR - 92 :</b> |      |                           |               |              |                 |
| SL. NO. | Code       | Description   | Unit | Qty.                      | Rate          | Indexed Rate | Amount          |
| 11      | 3.6.1      | Power wiring & plugs.   |      | 22208060                  | 4.00%         |              | 888322          |
| 12      | MR         | Copper wiring   |      | 22208060                  | 1.00%         |              | 222081          |
| 13      | MR         | Extra for modular switches                                    |      | 22208060                  | 1.50%         |              | 333121          |
| 14      | MR         | Superior fixtures   |      | 22208060                  | 2.50%         |              | 555202          |
| 15      | 3.6.4      | Telephone conduits  |      | 22208060                  | 0.50%         |              | 111040          |
| 16      | MR         | Extra for networking conduits                                 |      | 22208060                  | 0.50%         |              | 111040          |
| 17      | MR         | Smoke detection system & fire alarm                           | Sqm. | 3710                      | 325           |              | 1205750         |
| 18      | LS         | UPS wiring & distribution                                     | LS   |                           |               |              | 160000          |
| 19      | LS         | Cable tray  |      |                           |               |              | 60000           |
| 20      | LS         | Telephone System wiring                                       |      |                           |               |              | 40000           |
|         |            | <b>Total D</b>  |      |                           |               |              | <b>3686556</b>  |
|         |            | <b>TOTAL ( A + B + C + D )</b>                                |      |                           |               |              | <b>42132840</b> |



| Name of work : Construction of LECTURE HALL & CLASS ROOM COMPLEX PHASE I at PDPM IIITDM Jabalpur. |      |   |      |      |      |              |                 |
|---|------|---|------|------|------|--------------|-----------------|
| APPENDIX II   |      |   |      |      |      |              |                 |
| Extra for superior specifications & Architectural features  |      |   |      |      |      |              |                 |
| Preliminary Estimate based on DSR 2002 & market rate:   |      |   |      |      |      |              |                 |
| Extra for superior specifications & Architectural features based on DSR 2002 & market rate:       |      |   |      |      |      |              |                 |
| SL. NO.   | Code | Description                                   | Unit | Qty. | Rate | Indexed Rate | Amount          |
| 1   | DSR  | Extra for kota stone flooring                 | Sqm. | 4545 | 354  | 437          | 1984623         |
| 2   | DSR  | Extra for false ceiling - Gypsum              | Sqm. | 850  | 417  | 515          | 437395          |
| 3   | DSR  | Extra for Oil bound distemper                 | Sqm. | 9385 | 25   | 31           | 290302          |
| 4   | MR   | Extra for vitrified tiles flooring            | Sqm. | 200  | 1000 | 1000         | 200000          |
| 5   | MR   | Extra for Jaisalmer flooring                  | Sqm. | 350  | 1150 | 1150         | 402500          |
| 6   | MR   | Extra for Granite flooring                    | Sqm. | 100  | 3000 | 3000         | 300000          |
| 7   | MR   | Extra for wall panelling - Acoustic           | Sqm. | 1550 | 1950 | 1950         | 3022500         |
| 8   | MR   | Extra for Aluminium Doors frames              | Sqm. | 225  | 540  | 667          | 150040          |
| 9   | MR   | Extra for using aluminium windows             | Sqm. | 275  | 950  | 1173         | 322618          |
| 10  | MR   | Extra for Lamination on door                  | Sqm. | 365  | 600  | 600          | 219000          |
| 11  | MR   | Extra for S.S.Hardware on door                | LS   |      |      |              | 250000          |
| 12  | MR   | Extra for stone cladding                      | Sqm. | 1350 | 700  | 700          | 944720          |
| 13  | MR   | Extra for Grit Plaster/Spectrum Finish        | Sqm. | 3550 | 250  | 250          | 887600          |
| 14  | MR   | Extra for Acousticon Acoustical plaster       | Sqm. | 1470 | 950  | 950          | 1396500         |
| 15  | MR   | Extra for external grade Paint for steel work | Sqm. | 925  | 325  | 325          | 300625          |
| <b>Total</b>  |      |   |      |      |      | <b>Rs.</b>   | <b>11108423</b> |



| Name of work : Construction of LECTURE HALL & CLASS ROOM COMPLEX PHASE I at PDPM IIITDM Jabalpur. |      |  |       |      |       |                        |
|---|------|--|-------|------|-------|------------------------|
| APPENDIX III  |      |  |       |      |       |                        |
| Extra for Energy Efficient Features   |      |  |       |      |       |                        |
| Preliminary Estimate based on DSR 2002 & market rate:   |      |  |       |      |       |                        |
| Extra for Energy Efficient features based on DSR 2002 & market rate:                              |      |  |       |      |       |                        |
| SL. NO.   | Code | Description                            | Unit  | Qty. | Rate  | Indexed Rate<br>Amount |
| 1   | MR   | Extra for 300 mm cavity wall           | Sq.m. | 2700 | 130   | 351000                 |
| 2   | MR   | Extra for Wall insulation treatment    | Sq.m  | 850  | 350   | 297500                 |
| 3   | MR   | Extra for over deck insulation         | Sq.m. | 700  | 634   | 443520                 |
| 4   | MR   | Extra for China mosaic                 | Sq.m. | 700  | 235   | 164500                 |
| 5   | MR   | Extra for Hollow Brick Tile            | Sq.m. | 800  | 516   | 412800                 |
| 6   | MR   | Extra for pergola/Trellis              | Sq.m. | 400  |       | 800000                 |
| 7   | MR   | Extra for insulated Glass              | Sq.m. | 85   | 3000  | 255000                 |
| 8   | MR   | Extra for using High performance Glass | Sq.m. | 140  | 1500  | 210000                 |
| <b>Total</b>  |      |  |       |      |       | <b>Rs. 2934320</b>     |
| Name of work : Construction of LECTURE HALL & CLASS ROOM COMPLEX PHASE I at PDPM IIITDM Jabalpur. |      |  |       |      |       |                        |
| APPENDIX IV   |      |  |       |      |       |                        |
| Air Conditioning Work   |      |  |       |      |       |                        |
| SL. NO.   | Code | Description                            | Unit  | Qty. | Rate  | Indexed Rate<br>Amount |
| 1   | MR   | Air conditioning works (Low side only) | Ton   | 60   | 38000 | 2280000                |
| <b>Total</b>  |      |  |       |      |       | <b>Rs. 2280000</b>     |



PRELIMINARY ESTIMATE FOR LECTURE HALL & CLASS ROOM COMPLEX PHASE I at PDPM IIITDM, JABALPUR

SUMMARY OF COST

| S.No. | Description   | Amount in Rs, |
|-------|---|---------------|
| 1     | Framed Structure as per Appendix I  | 42132840      |
| 2     | Extra for superior specifications & Architectural features as per Appendix II | 11108423      |
| 3     | Extra for Energy Efficient Features as per Appendix III                       | 2934320       |
| 4     | Air Conditioning Work as per Appendix IV                                      | 2280000       |
|       | <b>Total</b>  | 58455583      |
| 5     | Architect Fees @ 5.612% (5% Fees + Service Tax @ 12.24%) of (A)               | 3280527       |
| 6     | Cost of Project Management @ 1.5% of (A)                                      | 876834        |
| 7     | Contingencies ( Lump Sum )  | 500000        |
|       | <b>GRAND TOTAL</b>  | 63112944      |

Prepared by

Sd/-

M/s Kanvinde Rai Chowdhury  
Architect

Checked by

Sd/-

T.S. Anand  
A. E., PDPM IIITDM

Recommended by

Sd/-

Rajeev Garg  
E. E., IIT Kanpur



| Name of work : Construction of LECTURE HALL & CLASS ROOM COMPLEX PHASE I at PDPM IIITDM Jabalpur. |        |   |      |      |      |              |                 |
|---|--------|---|------|------|------|--------------|-----------------|
| APPENDIX I  |        |   |      |      |      |              |                 |
| FRAMED STRUCTURE  |        |   |      |      |      |              |                 |
| Preliminary Estimate based on DPAR 92 & MR.   |        |   |      |      |      |              |                 |
| I : Civil Work (Based on DPAR-92 with C.I. = 205)   |        |   |      |      |      |              |                 |
| SL. NO.   | Code   | Description   | Unit | Qty. | Rate | Indexed Rate | Amount          |
| 1   | 1      | <b>RCC Framed Structure :</b>   |      |      |      |              |                 |
|   |        | RCC framed structure upto six storey's  |      |      |      |              |                 |
| 1   | 1.1.1  | Floor height 3.35 m   | Sqm  | 3710 | 2920 | 5986         | 22208060        |
| 2   | 1.2    | <b>Extra for :</b>  |      |      |      |              |                 |
|   |        | Extra for 1.15m of additional floor height beyond normal floor height of 3.35m.   | Sqm  | 1700 | 479  | 982          | 1669907         |
|   |        | Extra for 1.65m of additional floor height beyond normal floor height of 3.35m.   | Sqm  | 660  | 688  | 1409         | 930217          |
|   |        | Extra for 1.95m of additional floor height beyond normal floor height of 3.35m.   | Sqm  | 1350 | 813  | 1666         | 2248666         |
| 3   | 1.2.8  | Resisting Earthquake forces   | Sqm  | 3710 | 250  | 513          | 1901375         |
| 4   | 1.2.12 | Larger modules over 35 sqm.   | Sqm  | 2890 | 220  | 451          | 1303390         |
| 5   | 1.2.13 | Termite proof treatment (On ground floor only)                                    | Sqm  | 2450 | 75   | 154          | 376688          |
| 6   | 1.2.14 | Fire fighting   | Sqm  | 3710 | 185  | 379          | 1407018         |
| 7   | DSR    | Extra shuttering for Folded plate structure (DSR Item Code No. 5.14.9 + 5.14.10 ) | Sqm  | 1500 | 578  | 714          | 1071029         |
|   |        | <b>Total A</b>  |      |      |      | <b>Rs.</b>   | <b>33116349</b> |
|   |        | <b>Building Cost (sl. No.1)</b>   |      |      |      |              | <b>22208060</b> |



| SL. NO. | Code     | Description   | Unit | Building Cost at sl. No.1 | Rate          | Indexed Rate | Amount          |
|---------|----------|---|------|---------------------------|---------------|--------------|-----------------|
|         | <b>3</b> | <b>Services :</b>   |      |                           |               |              |                 |
| 8       | 3.1      | Internal water supply and sanitary installation               |      | 22208060                  | 4%            |              | 888322          |
| 9       | 3.2      | External service connections                                  |      | 22208060                  | 5%            |              | 1110403         |
|         |          | <b>Total B</b>  |      |                           |               | <b>Rs.</b>   | <b>1998725</b>  |
|         |          | <b>II : Electrical Work</b>                                   |      | <b>Building cost</b>      |               |              |                 |
| 10      | 3.3      | Internal electrical installations                             |      | 22208060                  | 15.00%        |              | 3331209         |
|         |          | <b>Total C</b>  |      | <b>Total</b>              | <b>15.00%</b> |              | <b>3331209</b>  |
|         | 3.6      | <b>Extra for superior specifications based on DPAR - 92 :</b> |      |                           |               |              |                 |
| SL. NO. | Code     | Description   | Unit | Qty.                      | Rate          | Indexed Rate | Amount          |
| 11      | 3.6.1    | Power wiring & plugs.   |      | 22208060                  | 4.00%         |              | 888322          |
| 12      | MR       | Copper wiring   |      | 22208060                  | 1.00%         |              | 222081          |
| 13      | MR       | Extra for modular switches                                    |      | 22208060                  | 1.50%         |              | 333121          |
| 14      | MR       | Superior fixtures   |      | 22208060                  | 2.50%         |              | 555202          |
| 15      | 3.6.4    | Telephone conduits  |      | 22208060                  | 0.50%         |              | 111040          |
| 16      | MR       | Extra for networking conduits                                 |      | 22208060                  | 0.50%         |              | 111040          |
| 17      | MR       | Smoke detection system & fire alarm                           | Sqm. | 3710                      | 325           |              | 1205750         |
| 18      | LS       | UPS wiring & distribution                                     | LS   |                           |               |              | 160000          |
| 19      | LS       | Cable tray  |      |                           |               |              | 60000           |
| 20      | LS       | Telephone System wiring                                       |      |                           |               |              | 40000           |
|         |          | <b>Total D</b>  |      |                           |               |              | <b>3686556</b>  |
|         |          | <b>TOTAL ( A + B + C + D )</b>                                |      |                           |               |              | <b>42132840</b> |





| Name of work : Construction of LECTURE HALL & CLASS ROOM COMPLEX PHASE I at PDPM IIITDM Jabalpur. |      |   |      |      |      |              |                 |
|---|------|---|------|------|------|--------------|-----------------|
| APPENDIX II   |      |   |      |      |      |              |                 |
| Extra for superior specifications & Architectural features  |      |   |      |      |      |              |                 |
| Preliminary Estimate based on DSR 2002 & market rate:   |      |   |      |      |      |              |                 |
| Extra for superior specifications & Architectural features based on DSR 2002 & market rate:       |      |   |      |      |      |              |                 |
| SL. NO.   | Code | Description                                   | Unit | Qty. | Rate | Indexed Rate | Amount          |
| 1   | DSR  | Extra for kota stone flooring                 | Sqm. | 4545 | 354  | 437          | 1984623         |
| 2   | DSR  | Extra for false ceiling - Gypsum              | Sqm. | 850  | 417  | 515          | 437395          |
| 3   | DSR  | Extra for Oil bound distemper                 | Sqm. | 9385 | 25   | 31           | 290302          |
| 4   | MR   | Extra for vitrified tiles flooring            | Sqm. | 200  | 1000 | 1000         | 200000          |
| 5   | MR   | Extra for Jaisalmer flooring                  | Sqm. | 350  | 1150 | 1150         | 402500          |
| 6   | MR   | Extra for Granite flooring                    | Sqm. | 100  | 3000 | 3000         | 300000          |
| 7   | MR   | Extra for wall panelling - Acoustic           | Sqm. | 1550 | 1950 | 1950         | 3022500         |
| 8   | MR   | Extra for Aluminium Doors frames              | Sqm. | 225  | 540  | 667          | 150040          |
| 9   | MR   | Extra for using aluminium windows             | Sqm. | 275  | 950  | 1173         | 322618          |
| 10  | MR   | Extra for Lamination on door                  | Sqm. | 365  | 600  | 600          | 219000          |
| 11  | MR   | Extra for S.S.Hardware on door                | LS   |      |      |              | 250000          |
| 12  | MR   | Extra for stone cladding                      | Sqm. | 1350 | 700  | 700          | 944720          |
| 13  | MR   | Extra for Grit Plaster/Spectrum Finish        | Sqm. | 3550 | 250  | 250          | 887600          |
| 14  | MR   | Extra for Acousticon Acoustical plaster       | Sqm. | 1470 | 950  | 950          | 1396500         |
| 15  | MR   | Extra for external grade Paint for steel work | Sqm. | 925  | 325  | 325          | 300625          |
|   |      | <b>Total</b>                                  |      |      |      | <b>Rs.</b>   | <b>11108423</b> |



| Name of work : Construction of LECTURE HALL & CLASS ROOM COMPLEX PHASE I at PDPM IIITDM Jabalpur. |      |  |      |      |       |              |                |
|---|------|--|------|------|-------|--------------|----------------|
| APPENDIX III  |      |  |      |      |       |              |                |
| Extra for Energy Efficient Features   |      |  |      |      |       |              |                |
| Preliminary Estimate based on DSR 2002 & market rate:   |      |  |      |      |       |              |                |
| Extra for Energy Efficient features based on DSR 2002 & market rate:                              |      |  |      |      |       |              |                |
| SL. NO.   | Code | Description                            | Unit | Qty. | Rate  | Indexed Rate | Amount         |
| 1   | MR   | Extra for 300 mm cavity wall           | Sqm. | 2700 | 130   | 130          | 351000         |
| 2   | MR   | Extra for Wall insulation treatment    | Sqm  | 850  | 350   | 350          | 297500         |
| 3   | MR   | Extra for over deck insulation         | Sqm. | 700  | 634   | 634          | 443520         |
| 4   | MR   | Extra for China mosaic                 | Sqm. | 700  | 235   | 235          | 164500         |
| 5   | MR   | Extra for Hollow Brick Tile            | Sqm. | 800  | 516   | 516          | 412800         |
| 6   | MR   | Extra for pergola/Trellis              | Sqm. | 400  |       |              | 800000         |
| 7   | MR   | Extra for insulated Glass              | Sqm. | 85   | 3000  | 3000         | 255000         |
| 8   | MR   | Extra for using High performance Glass | Sqm. | 140  | 1500  | 1500         | 210000         |
|   |      | <b>Total</b>                           |      |      |       | <b>Rs.</b>   | <b>2934320</b> |
| Name of work : Construction of LECTURE HALL & CLASS ROOM COMPLEX PHASE I at PDPM IIITDM Jabalpur. |      |  |      |      |       |              |                |
| APPENDIX IV   |      |  |      |      |       |              |                |
| Air Conditioning Work   |      |  |      |      |       |              |                |
| SL. NO.   | Code | Description                            | Unit | Qty. | Rate  | Indexed Rate | Amount         |
| 1   | MR   | Air conditioning works (Low side only) | Ton  | 60   | 38000 | 38000        | 2280000        |
|   |      | <b>Total</b>                           |      |      |       | <b>Rs.</b>   | <b>2280000</b> |



PRELIMINARY ESTIMATE FOR LECTURE HALL & CLASS ROOM COMPLEX PHASE I at PDPM IIITDM, JABALPUR

SUMMARY OF COST

| S.No. | Description   | Amount in Rs, |
|-------|---|---------------|
| 1     | Framed Structure as per Appendix I  | 42132840      |
| 2     | Extra for superior specifications & Architectural features as per Appendix II | 11108423      |
| 3     | Extra for Energy Efficient Features as per Appendix III                       | 2934320       |
| 4     | Air Conditioning Work as per Appendix IV                                      | 2280000       |
|       | <b>Total</b>  | 58455583      |
| 5     | Architect Fees @ 5.612% (5% Fees + Service Tax @ 12.24%) of (A)               | 3280527       |
| 6     | Cost of Project Management @ 1.5% of (A)                                      | 876834        |
| 7     | Contingencies ( Lump Sum )  | 500000        |
|       | <b>GRAND TOTAL</b>  | 63112944      |

Prepared by

Sd/-

M/s Kanvinde Rai Chowdhury  
Architect

Checked by

Sd/-

T.S. Anand  
A. E, PDPM IIITDM

Recommended by

Sd/-

Rajeev Garg  
E. E, IIT Kanpur





**Pt. DWARKA PRASAD MISHRA INDIAN INSTITUTE OF INFORMATION  
TECHNOLOGY DESIGN & MANUFACTURING JABALPUR**

IITK Camp Office:  
Post Office- IIT, Kanpur-208016  
Jabalpur Campus:  
IT Building Govt. Engg. College  
Jabalpur

No. IIITDMJ/2006/82

Dated: 06.07.06

Minutes of the meeting of Campus Advisory Committee for campus planning of PDPMIIITDM Jabalpur, held on 29.06.2006 at Visitor's Hostel, IIT Kanpur.

The following were present:

1. Dr. Sanjeev Bhargava
2. Dr. Punit Tandon
3. Dr. C. V. R. Murty
4. Dr. Manoj Harbola
5. Shri Rajeev Garg
6. Shri Sanjay Kanvinde

The proposed Master plan of the campus and the detail planning for Hostels, Teaching Labs, Lecture Hall / Classroom Complex and Guest House were presented by the Architect. The Chairman informed the Architect that a preliminary meeting of the advisory committee was held on 21.06.2006 and the above plans were discussed except Guest House. The members raised some observations and suggested the following:

- 1) In the master plan, the location of type- III and Type II houses may be switched over with each other.
- 2) Instead of having a dining hall and kitchen with each hostel, a central messing facility may be created in a separate three storeyed building.
- 3) One additional wing may be added in place of proposed dining hall and kitchen in each hostel.
- 4) The loaded stilted in the hostel building is not desirable from the point of view earthquake resistant structure.
- 5) A separate canteen in each hostel with the seating capacity of 40 students may be created.
- 6) The shape of the central lounge in hostel may be modified suitably.
- 7) The specifications of the proposed construction are OK.
- 8) The residential wing of the hostel is not straight there is an angular connection near staircase and toilet. The structure designer should analyse the design on the basis of earthquake consideration, if need the seismic joint conforming IS code may be created.
- 9) In Teaching Lab Complex, addition labs may be created in the stilted cycle path.



- 10) In Lecture Hall Complex additional classrooms of 75 capacities in the stilted cycle path may be created.
- 11) An additional toilet block and staircase near the classroom is desirable.
- 12) All the loaded stilted structures should be designed carefully considering the earthquake consideration of latest IS code.
- 13) All the floors of all Academic buildings should have universal excess.
- 14) The location of sub station in the master plan should be re-considered in view that HT cable should not cross the Academic Area.

After the detailed discussions and deliberations on the above suggestions the architect has agreed to consider and make the changes in the drawings and estimates already submitted. The drawings of the Guesthouse were also discussed by the committee and certain modifications were suggested to the architect.

Sd/-  
(Rajeev Garg)  
Superintending Engineer  
PDPM IIITDM, Jabalpur

Approved

Sd/-  
Dr. Sanjeev Bhargava  
Director  
PDPM IIITDM, Jabalpur